

#6 SELF-TAPPING
SCREW (TYP)

AL8235 - 1 1/4" FACE TRIM

AL8051 - 2" MAP RAIL WITH
FORBO PLAS-CORK INSERT

L-CLIP (TYP)

-- GA PORCELAIN ENAMELED
STEEL WRITING SURFACE

1/2" -----BOARD CORE

----- ALUMINUM BACKER

AL8237 - 2 3/4" DEPTH

#10 SCREW WITH
PLASTIC SCREW
ANCHOR (TYP)

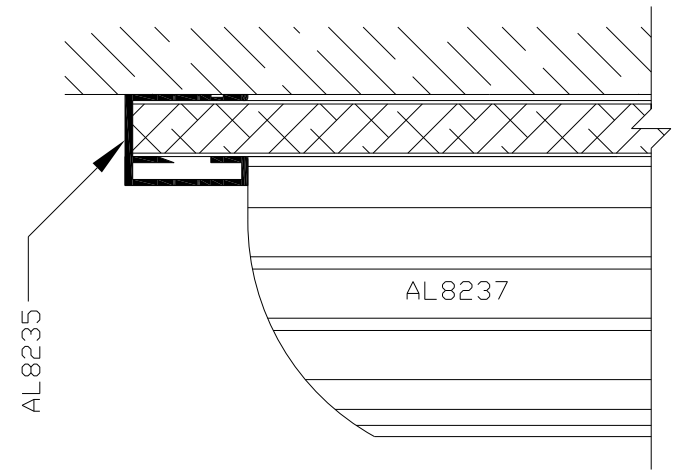

TOP SECTION VIEW

SCALE: 1/2

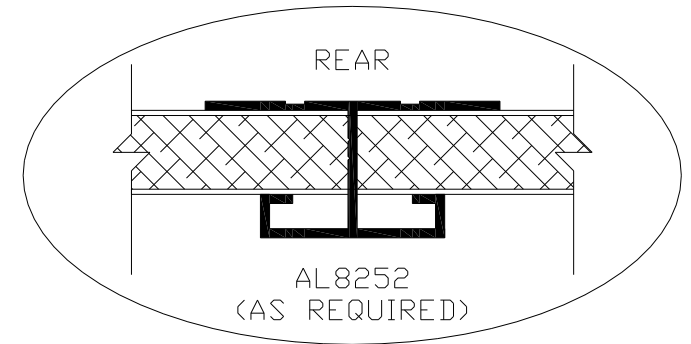

CHALKBOARD/MARKERBOARD
SERIES 1662

<u>PROJECT:</u>		-		<u>JOB #</u>	
---		---		-----	
<u>DATE:</u>	---/---/---	<u>DRAWN BY:</u>	TCW	<u>SCALE:</u>	3/4
<u>SUBMITTED FOR:</u>		-			
		-			
		-			
<u>MANUFACTURED BY:</u>		MARSH INDUSTRIES, INC.			
		PO BOX 1000 - NEW PHILADELPHIA, OH 44663-5100			
		PH: (330) 308-8865 FAX: (330) 339-5875			
THIS DRAWING IS PROPRIETARY TO MARSH INDUSTRIES, INC. AND IS FURNISHED SUBJECT TO AN EXPRESSED AGREEMENT NOT TO USE OR DISCLOSE, DIRECTLY OR INDIRECTLY, FOR ANY PURPOSE. THIS LEGEND SHALL BE MARKED UPON ANY REPRODUCTION IN WHOLE OR IN PART HEREOF.				<u>SHEET</u>	<u>OF</u>
				-	-